



OCQG BLOCK OF THE MONTH
JUNE 2021

Oh, no!
There are Rabbits in our Garden!

Create these fun rabbits
for your garden quilt
or for a rabbit quilt top.
Piece or applique
and even reverse them
for more variety.

Pieced 7 1/2" bunny unfinished



Fabric needed: floral background with no nap,
Bunny fabric, batting for cotton tail, black eye.

From black fabric cut 1" square for bunny eye.

From rabbit print cut:

- 1 x 1 square (B)
- 1 x 1 1/2 rectangle (C)
- 1 1/4 square foot (D)
- 1 1/2 x 2 1/2 rectangle face (E)
- 3 1/4 x 3 1/4 rectangle body (F)
- 2 1/2 x 1 3/4 rectangle head (G)
- 2 1/4 x 3 rectangle ear (H)
- 2 3/4 x 2 1/2 rectangle chest (I)

From background floral fabric with no nap cut:

- 1 inch square #1
- 1 1/4 x 2 rectangle #2
- Three 1 1/2 squares #3
- 1 3/4 x 3 3/4 rectangle #4
- 2 1/4 square #5
- 2 1/4 x 4 rectangle #6

Two 1 x 6 1/2 borders #7

Two 1 x 7 1/2 borders #

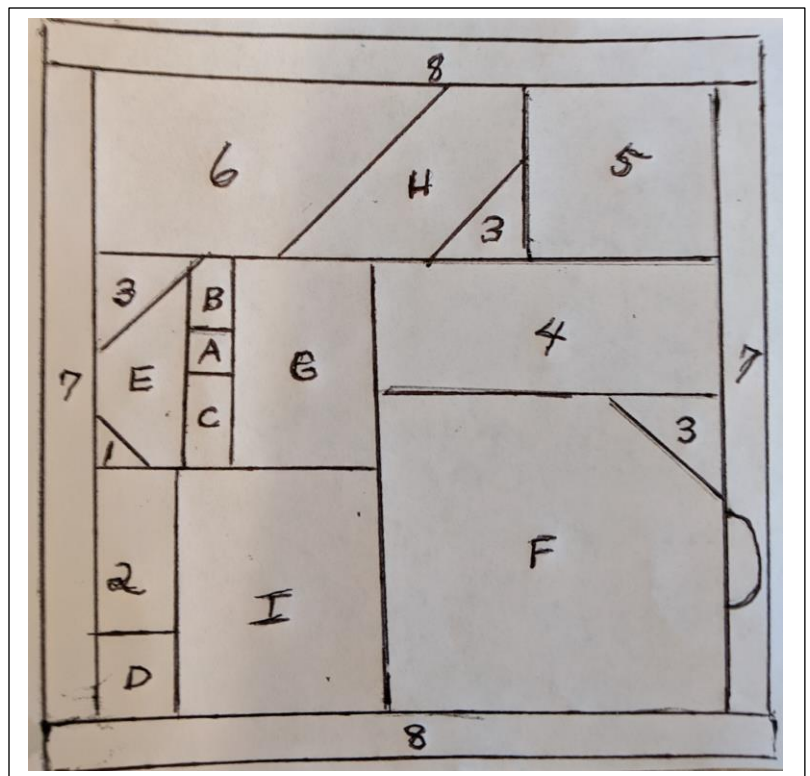

Following the diagram, piece the eye section with A, B (on top) and C.

Attach face E and head G to the eye section.

Snowball **** with # 3 on top and # 1 on bottom of face (E), completing the shape of the head.

Attach #2 to D and both to (I) for the foot and the chest.

Snowball a #3 to upper right corner of F, and then attach #4 to F, completing the body of the bunny.

For the ear portion, lay #6 right sides together and perpendicular to upper left corner of H

Draw a line from the upper right corner of #6 to the lower left corner 2 ¼ inches down where it intersects the other side of H.

Stitch from upper right corner to lower left. Press towards back and trim lower layers.

Next, snowball lower right corner of H with another #3 square. Attach #5.

Attach this ear to top of rabbit head and body.

Add the two short borders # 7 on the sides and the two long borders #8 on the top and bottom.

Fuse and stitch down a half circle of batting for the bunny's cotton tail.

**** Snowball means to lay your #3 square right sides together on the corner of the face (E). In this case it is the upper left corner. Draw a line from the upper right corner to the lower left corner of # 3 and stitch along this line. Flipping the material over, check that your edges are squared up to the base (bunny) fabric, trimming if necessary. When satisfied cut off the bottom two layers and press.



Two choices for applique bunnies:

On a 7 ½ by 10 ½ floral or shrub background (paying attention to fabric nap) as one bunny is horizontally leaping and the other is vertically sitting, trace, fuse and stitch down your bunnies, using a strong zig zag or satin stitch to showcase the anatomical lines. Use a dark round fabric for the eye and stitch down a piece of cotton batting for the cotton tail!

Put your name in Once for each rabbit turned in (Maximum of 5). Questions?

Contact Cheri Hansen at 714-528-1836 or hansen.cheri@gmail.com or

Brigette Brink at 714-469-2076 bbrink5785@gmail.com

